

ENVOY 2 S SERIES

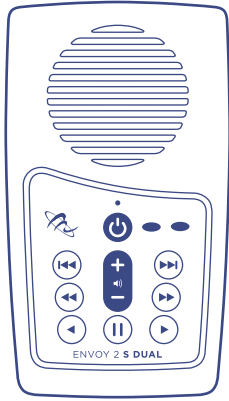

SOLAR AUDIO PLAYER

Models: S Dual, S, ST

*Envoy 2 S Dual Pictured

USER MANUAL >

TURNING THE PLAYER ON/OFF

Press the button for 2 seconds to turn the player on and begin playback mode (it will beep once). Press the button briefly to turn the player off (it will beep twice).

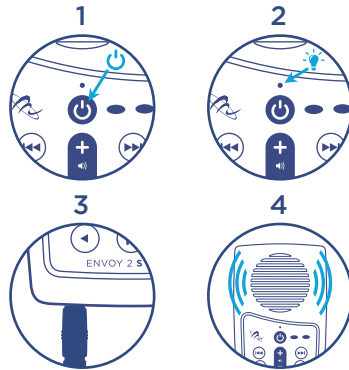

1

2

3

SELECTING A LANGUAGE GROUP

GREEN* BROWN**

While playing one Language group, pressing on the second Language button will navigate to the beginning of the second Language group.

#If your player came with the Cross Navigation feature, pressing the second Language button will navigate to the beginning of the corresponding Chapter.

**Applies to the Envoy 2 S and Envoy 2 S Dual only.*

***Applies to the Envoy 2 S Dual only.*

NAVIGATING DURING PLAYBACK

Each Language group is subdivided into one or more Sections, containing one or more Books, containing one or more Chapters.

GREEN*

While in the first Language group, press the Green button to skip to the next Section of the Green Language.

BROWN**

While in the second Language group, press the Brown button to skip to the next Section of the Brown Language.

Press or to jump backward or forward one book. A long press will skip 3 books at a time.

Press or to jump backward or forward one chapter. A long press will skip 5 chapters at a time.

Press or to jump backward or forward *approximately* 10 seconds#. A long press will keep navigating backward or forward until the button is released or the end/beginning of the file is reached.

#The actual time skipped may vary slightly.

EARPHONES, SPEAKERS AND VOLUME

Insert earphone or speaker plug into the standard 3.5mm audio jack on the bottom of the player.

4

Press or to decrease or increase volume. The volume will remain set at this level even after the player is turned off and restarted.

PAUSING/ BOOKMARKING

Press to pause playback. To resume, press or one of the other navigation buttons ().

If the player is paused, the player will beep once and place the bookmark at that position. When the player is turned back on later, playback will begin from the bookmark.

**The player supports a single playback bookmark.*

5

CHANGE/RESET THE BOOKMARK

To reset the bookmark to the beginning of the message, follow these steps:

1. While the player is on, press .
2. After pausing the player, press for 2 seconds (it will beep once).
3. The bookmark is now reset to the beginning.

You may resume playback or turn the player off.

6

CHARGING INSTRUCTIONS

With proper care, the player's Lithium-Ion battery should perform well for several years. When shipped, the battery is only partially charged. Please fully charge the player before the first use following one of the charging methods below:

For fastest charge, connect any standard "USB" charger (regulated +5VDC, minimum 300mA) to the micro-USB port on the player for about 2 hours until the light stops blinking.

Plug player into any standard computer USB port using a "USB to micro-USB" cable for about 3 hours until the light stops blinking.

7

☀ For solar charging, place the player with the solar panel facing bright sunlight for at least 8 hours.

Before storing the player for prolonged periods, make sure the battery is at least partially charged. If stored for extended periods, it is recommended to recharge the player every 6 months in order to prevent the battery from losing its ability to recharge.

Should the battery become damaged and unable to accept a charge, you can still operate the player using the power cord (charger).

8

CHARGING/ COMMUNICATION MODES

1. The player is on and in Playback mode.
2. Connect to a computer: the player will enter Computer Communication mode and turn itself off.
3. The player will connect with the computer.
4. Depending on the computer and the battery level, the LED will blink (Charging/communication indication).
5. After a few seconds, pressing  will disconnect the player from Computer Communication mode, and return to Playback mode.

9

6. At this point, physically disconnecting the player from the computer will stop the battery charging.
7. To connect to the computer again, the player will need to be unplugged and then reconnected.
8. While connected to the computer, the player's battery will be charging.

**Changing to Computer Communication mode is essential to allow programming of the player or Firmware.*

PROBLEMS WITH THE PLAYER?

If the unit will not turn on, please try the following:

1. Make sure the battery is charged

10

according to the "Charging Instructions".

2. If the battery is OK, force a reboot of the player by holding  for about 10 seconds. The player should restart automatically.

3. If #2 fails, reset the player by gently inserting the end of a paper clip for a few seconds into the reset hole on the back of the player, just above the left-most screw holding the back panel. This is the same as disconnecting/reconnecting the battery. Then try to turn the player on.

4. If none of the above succeeded, please contact your sales representative for support.

11

WARNINGS



- Care must be taken to set the volume at the lowest level that can be heard comfortably. Prolonged exposure to loud sound can cause gradual hearing loss.
- DO NOT expose player or battery to fire or extreme heat.
- Stop using player if you observe abnormal heat, odor, discoloration, leakage or deformation, especially near battery. Refer to a qualified technician for service.
- If the battery is removed from the player, handle it with care. Keep the exposed battery out of reach of children.

12

DO NOT burn, puncture, disassemble, or modify battery.

- If battery leaks, dispose of it carefully in accordance with all local laws. Wash any skin or clothing exposed to battery liquid and avoid swallowing or contact with eyes. In the case of swallowing or contact with eyes, seek medical care immediately.



Made in China

Envoy 2 S Series User Manual - US Letter - English - 2018.02.22-1.0.1

13

ENVOY 2 S SERIES

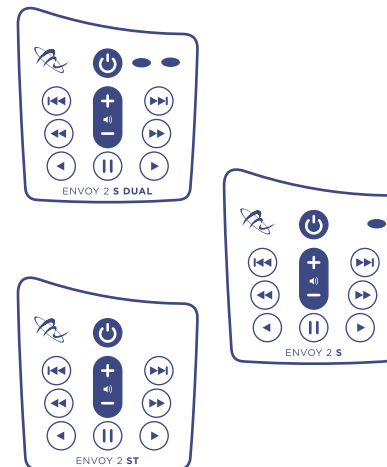

14

OTHER SIDES

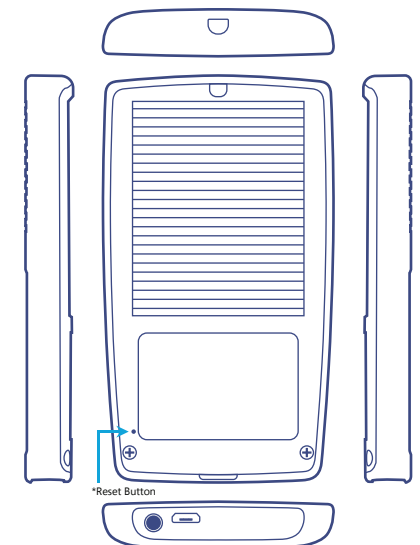

15